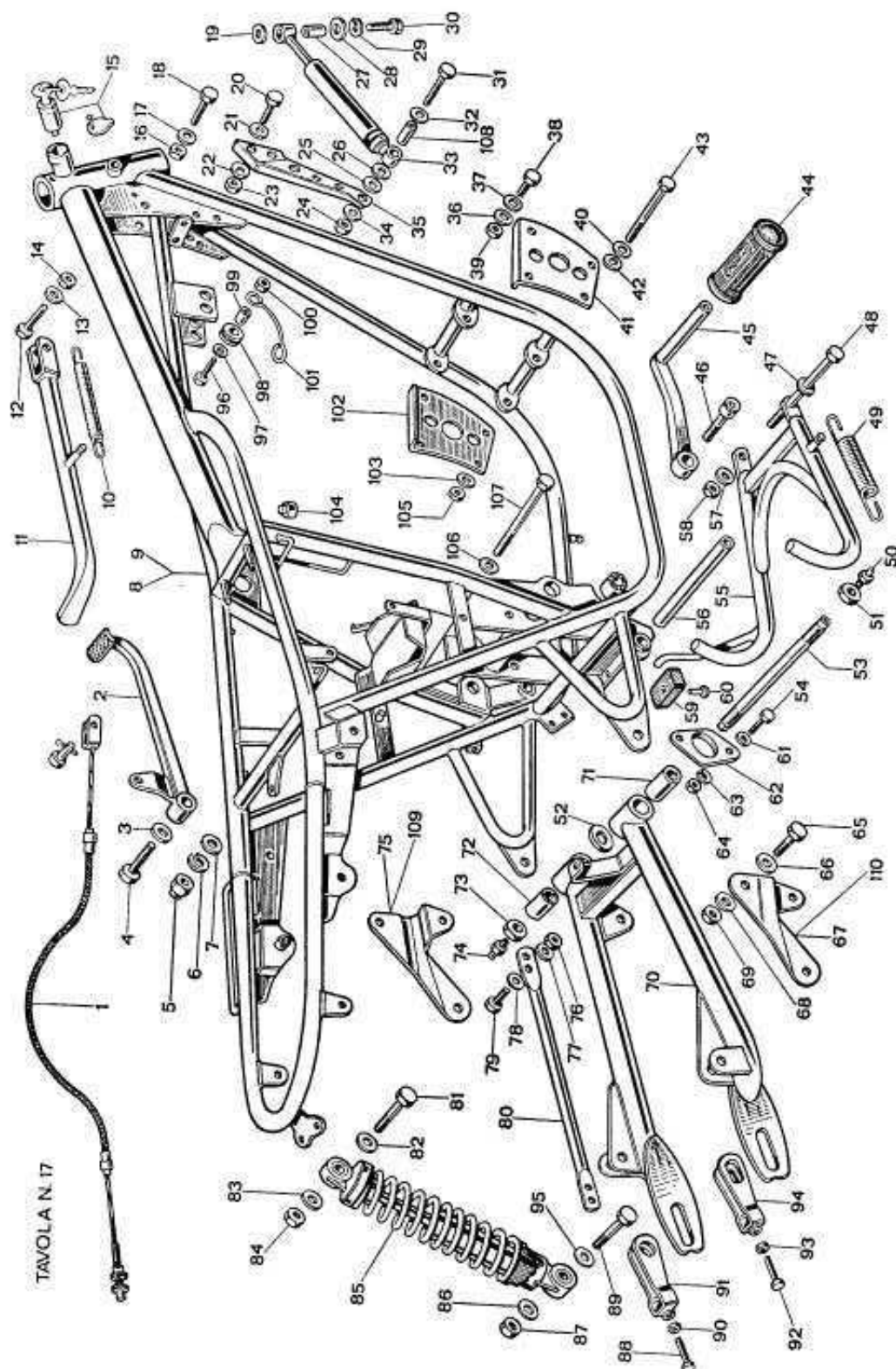

Table 17: Frame



No.	Code	Denominazione	Description
1	36.01.19	Trasmissione freno post. N. e S.	Rear brake cable - Standard & Sport
2	45.02.22	Pedale freno	Brake pedal
3	47.07.17	Rondella $\phi 8 \times 24$	Washer - $\phi 8 \times 24$
4	47.01.15	Vite TE $\phi 8 \times 14$	Screw - TE $\phi 8 \times 14$
5	47.03.22	Dado $8 \times 10,4$	Nut - $8 \times 10,4$
6	47.08.05	Rondella elast. $\phi 8$	Spring washer - $\phi 8$
7	47.07.07	Rondella $\phi 8 \times 18$	Washer - $\phi 8 \times 18$
8	45.01.15	Telaio Normale A/2	Frame - Standard A/2
	19.02.18		
9	45.01.16	Telaio Sport A/1	Frame - Sport A/1
	19.02.18		
10	22.01.23	Molla	Spring
11	45.02.21	Cavalletto laterale	Side prop stand
12	47.01.23	Vite TE $\phi 8 \times 30$	Screw - TE - $\phi 8 \times 30$
13	47.07.07	Rondella $\phi 8 \times 18$	Washer - $\phi 8 \times 18$
14	47.03.12	Dado $8 \times 6,5$	Nut - $8 \times 6,5$
15	19.02.19	Antifurto	Antitheft
16	47.03.03	Dado 5×5	Nut - 5×5
17	47.07.02	Rondella $\phi 5 \times 11$	Washer - $\phi 5 \times 11$
18	47.01.03	Vite TE $\phi 5 \times 14$	Screw - TE - $\phi 5 \times 14$
19	47.07.03	Rondella $\phi 6 \times 13$	Washer - $\phi 6 \times 13$
20	47.01.05	Vite TE $\phi 6 \times 16$	Screw - TE - $\phi 6 \times 6$
21	47.07.03	Rondella $\phi 6 \times 13$	Washer - $\phi 6 \times 13$
22	47.07.03	Rondella $\phi 6 \times 13$	Washer - $\phi 6 \times 13$
23	47.03.04	Dado 6×5	Nut - 6×5
24	47.03.04	Dado 6×5	Nut - 6×5
25	47.07.07	Rondella $\phi 8 \times 18$	Washer - $\phi 8 \times 18$
26	47.07.03	Rondella $\phi 6 \times 13$	Washer - $\phi 6 \times 13$
27	14.05.13	Boccola	Bush
28	47.07.13	Rondella $\phi 6 \times 18$	Washer - $\phi 6 \times 18$
29	47.08.05	Rondella elast. $\phi 8$	Spring washer - $\phi 8$
30	47.01.07	Vite TE $\phi 6 \times 30$	Screw - TE - $\phi 6 \times 30$
31	47.01.07	Vite TE $\phi 6 \times 30$	Screw - TE - $\phi 6 \times 30$
32	47.07.03	Rondella $\phi 6 \times 13$	Washer - $\phi 6 \times 13$
33	40.01.08	Ammortizzatore sterzo	Steering damper
34	47.07.03	Rondella $\phi 6 \times 13$	Washer - $\phi 6 \times 13$
35	15.06.19	Attacco ammortizz. sterzo	Connection piece for steering damper
36	47.07.07	Rondella $\phi 8 \times 18$	Washer - $\phi 8 \times 18$
37	47.07.07	Rondella $\phi 8 \times 18$	Washer - $\phi 8 \times 18$
38	47.01.32	Vite TE $\phi 8 \times 20$	Screw - TE - $\phi 8 \times 20$
39	47.03.22	Dado $\phi 8 \times 10,4$	Nut - $\phi 8 \times 10,4$
40	47.07.07	Rondella $\phi 8 \times 18$	Washer - $\phi 8 \times 18$
41	15.06.07	Supporto motore	Engine mounting - Right side
42	47.07.07	Rondella $\phi 8 \times 18$	Washer - $\phi 8 \times 18$
43	47.01.48	Vite TE $\phi 8 \times 120$	Screw - TE - $\phi 8 \times 120$
14	30.01.22	Copripedana	Footrest cover
45	45.02.19	Staffa	Stirrup
46	47.06.07	Vite TCCE $\phi 10 \times 30$	Screw - TCCE - $\phi 10 \times 30$
47	47.07.09	Rondella $\phi 10 \times 21$	Washer - $\phi 10 \times 21$
48	47.01.13	Vite TE $\phi 10 \times 140$	Screw - TE - $\phi 10 \times 140$

continued on next page

<i>continued from previous page</i>			
No.	Code	Denominazione	Description
49	22.01.40	Molla	Spring
50	26.01.01	Ingrassatore	Lubricating nipple
51	47.03.25	Dado 20×9	Nut - 20×9
52	15.06.16	Rondella	Washer
53	14.04.17	Perno	Pin
54	47.01.05	Vite TE $\phi 6 \times 13$	Screw - TE - $\phi 6 \times 16$
55	45.02.20	Cavalletto	Prop stand
56	14.05.12	Distanziale	Spacer
57	15.06.17	Rondella	Washer
58	47.03.09	Dado 10×6	Nut - 10×6
59	30.01.15	Paracoplo	Bumper
60	26.01.21	Ribattino	Rivet
61	47.07.03	Rondella $\phi 6 \times 13$	Washer - $\phi 6 \times 13$
62	15.06.02	Piastrina	Plate
63	47.08.03	Rondella elast. $\phi 6$	Spring washer - $\phi 6$
64	47.03.04	Dado 6×5	Nut - 6×5
65	47.01.19	Vite TE $\phi 10 \times 20$	Screw - TE - $\phi 10 \times 20$
66	47.07.09	Rondella $\phi 10 \times 21$	Washer - $\phi 10 \times 21$
67	15.06.12	Supporto silenz. norm. destro	Silencer support - Right side - N.
68	47.07.09	Rondella $\phi 10 \times 21$	Washer - $\phi 10 \times 21$
69	47.03.09	Dado 10×6	Nut - 10×6
70	45.01.17	Forcellone	Fork
71	25.02.12	Boccola	Bush
72	25.02.12	Boccola	Bush
73	47.03.24	Dado 14×8	Nut - 14×8
74	26.01.01	Ingrassatore	Lubricating nipple
75	15.06.13	Supporto silenz. norm. sinistro	Silencer support - Left side - N.
76	47.03.20	Dado 7×8,8	Nut - 7×8,8
77	47.07.06	Rondella $\phi 7 \times 14$	Washer - $\phi 7 \times 14$
78	47.07.06	Rondella $\phi 7 \times 14$	Washer - $\phi 7 \times 14$
79	47.01.38	Vite TE $\phi 7 \times 30$	Screw - TE - $\phi 7 \times 30$
80	45.03.08	Tirante	Stay rod
81	47.01.27	Vite TE $\phi 10 \times 40$	Screw - TE - $\phi 10 \times 40$
82	47.07.09	Rondella $\phi 10 \times 21$	Washer - $\phi 10 \times 21$
83	47.07.09	Rondella $\phi 10 \times 21$	Washer - $\phi 10 \times 21$
84	47.03.09	Dado 10×6	Nut - 10×6
85	40.01.07	Ammortizzatore	Shock absorber
86	47.07.09	Rondella $\phi 10 \times 21$	Washer - $\phi 10 \times 21$
87	47.03.09	Dado 10×6	Nut - 10×6
88	47.01.49	Vite TE $\phi 6 \times 50$	Screw - TE - $\phi 6 \times 50$
89	47.01.40	Vite TE $\phi 10 \times 45$	Screw - TE - $\phi 10 \times 45$
90	47.03.04	Dado 6×5	Nut - 6×5
91	15.06.10	Tendicatena sin.	Chain stretcher - Left side
92	47.01.49	Vite TE $\phi 6 \times 50$	Screw - TE - $\phi 6 \times 50$
93	47.03.04	Dado 6×5	Nut - 6×5
94	15.06.09	Tendicatena des.	Chain Stretcher - Right side
95	47.07.09	Rondella $\phi 10 \times 21$	Washer - $\phi 10 \times 21$
96	47.01.36	Vite TE $\phi 6 \times 25$	Screw - TE - $\phi 6 \times 25$
97	47.07.03	Rondella $\phi 6 \times 13$	Washer - $\phi 6 \times 13$
98	30.01.26	Antivibrante	Vibration damper
99	14.05.11	Boccola	Bush
<i>continued on next page</i>			

<i>continued from previous page</i>			
No.	Code	Denominazione	Description
100	47.03.04	Dado 6×5	Nut - 6×5
101	22.01.42	Passafile	Wire lead
102	15.06.08	Supporto motore sin.	Engine mounting - Left side
103	47.08.05	Rondella elast. $\phi 8$	Spring washer - $\phi 8$
104	30.01.28	Cappuccia	Cap
105	47.03.22	Dado 8×10,4	Nut - 8×10,4
106	47.07.07	Rondella $\phi 8 \times 18$	Washer - $\phi 8 \times 18$
107	47.01.48	Vite TE $\phi 8 \times 120$	Screw - TE - $\phi 8 \times 120$
108	14.05.13	Boccola	Bush
109	15.06.21	Supporto silenz. sport sin.	Silencer support - Left side - S.
110	15.06.20	Supporto silenz. sport destro	Silencer support - Right side - 0.