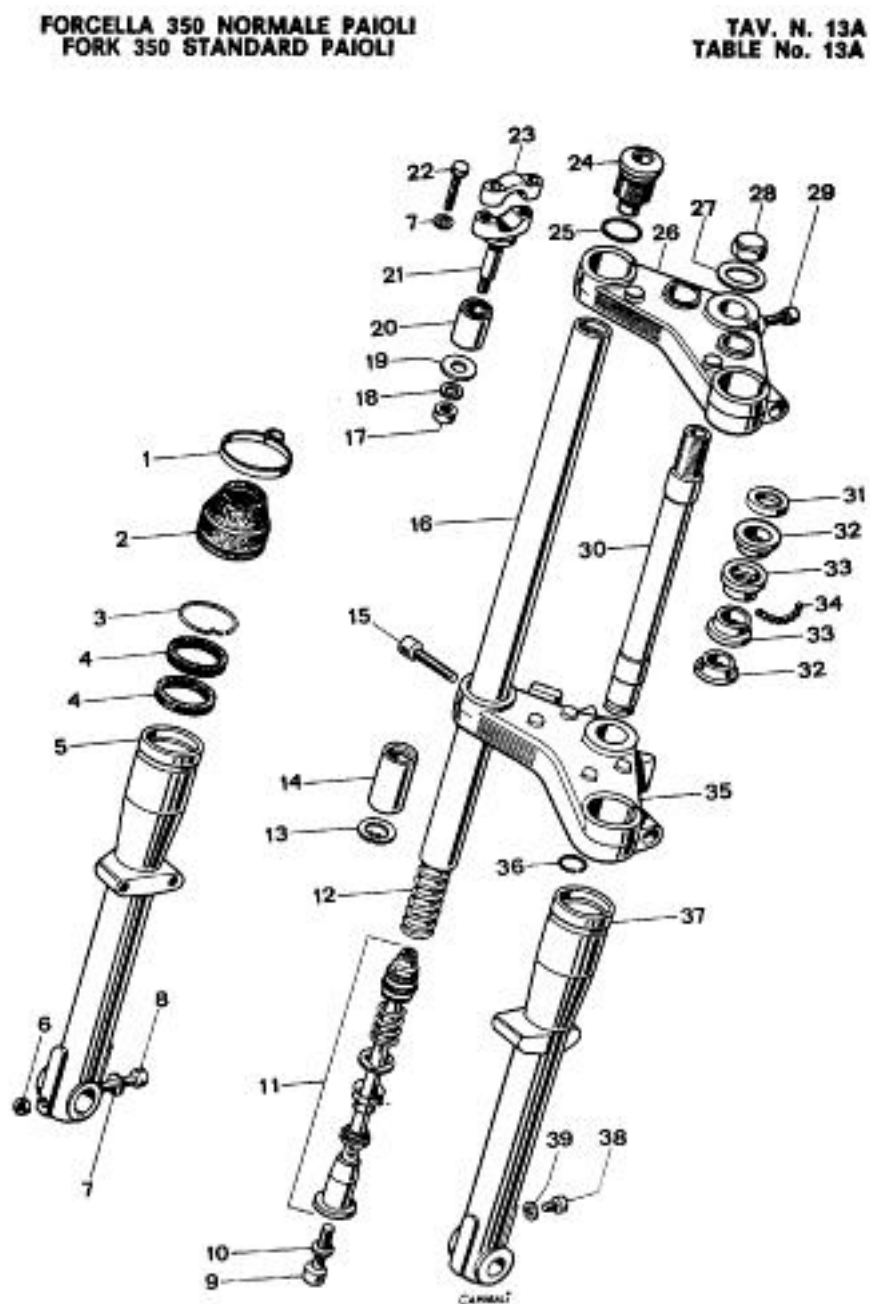
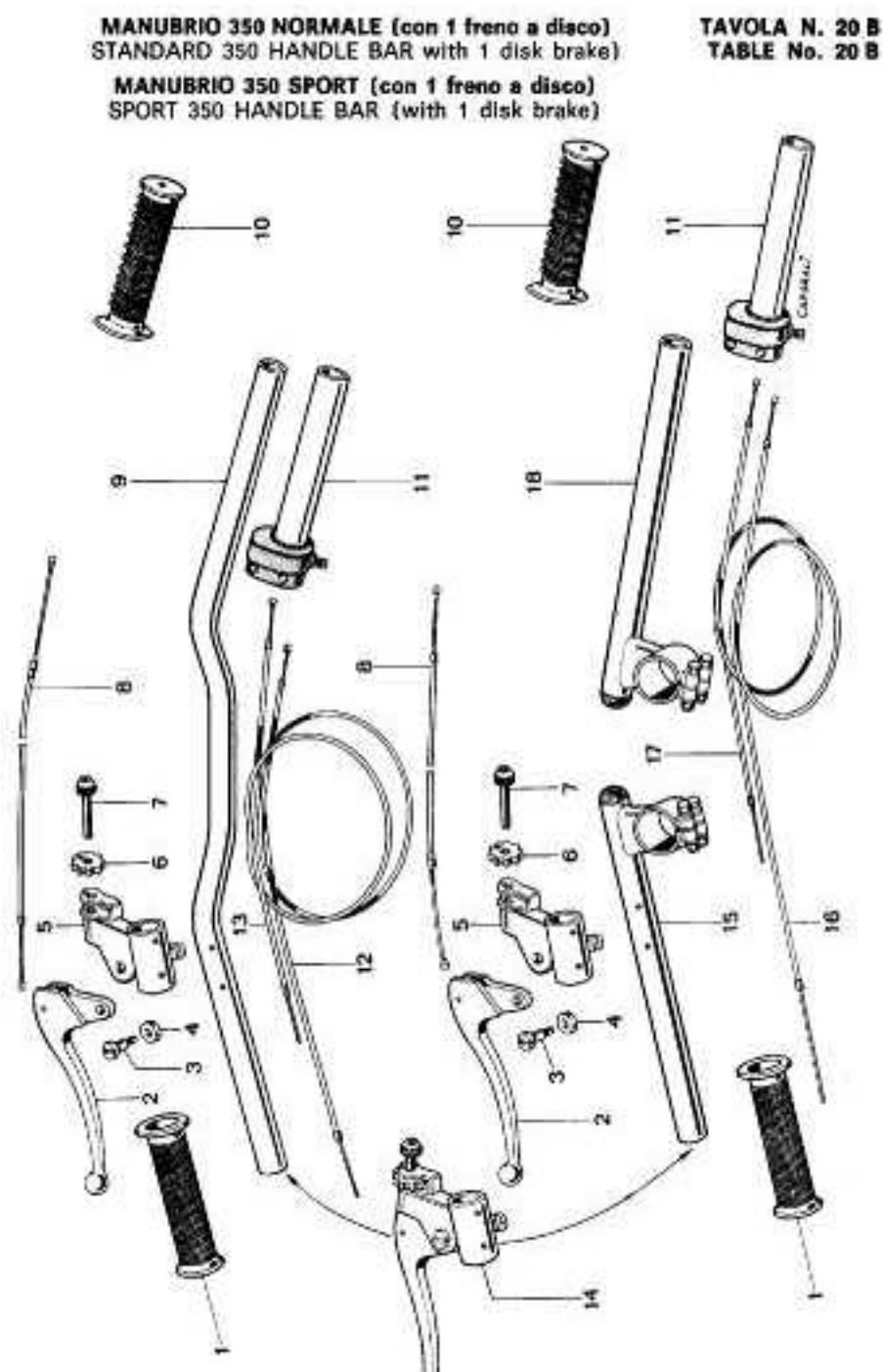

**Table 13A: Front Forks (Standard Paioli)**

No.	Code	Denominazione	Description
1	42.08.17	Fascetta elastica	Elastic clamp
2	42.08.18	Cuffia parapolvere	Dust cover guard
3	42.08.24	Anello tenuta paraolio	Oil seal ring
4	42.08.14	Paraolio $\phi 35$	Oil seal $\phi 35$
5	42.08.07	Gamba destra	Right leg
6	47.03.12	Dado $\phi 8$ MA	$\phi 8$ MA Nut
7	47.07.11	Rondella piana $\phi 8 \times 15$ VT. 714	Flat washer $\phi 8 \times 15$ VT. 714
8	47.01.30	Vite T.E. $\phi 8 \times 60$ VT. 141	Hexagonal head screw $\phi 8 \times 60$ VT. 141
9	42.08.25	Vite T.C.C.E. $\phi 12 \times 35$	Cheese-headed socket screw $\phi 12 \times 35$
10	42.08.26	Rondella rame $\phi 12$	Copper washer $\phi 12$
11	42.08.20	Gruppo freno idraulico	Hydraulic brake set
12	42.08.04	Molla forcella L.L. 500	Fork spring L.L. 500
13	42.08.27	Anello Seeger $\phi 32$	Circlip ring $\phi 32$
14	42.08.28	Boccola ammortizzatore	Shock absorber bush
15	42.08.29	Vite T.C.C.E. $\phi 10 \times 35$	Cheese-headed socket screw $\phi 10 \times 35$
16	42.08.03	Stelo $\phi 35$	Stem $\phi 35$
17	42.08.12	Dado fissaggio cavallotto	U Bolt securing nut
18	47.08.06	Rondella grower $\phi 10$	Grower washer $\phi 10$
19	42.08.30	Rondella $\phi 10 \times 30 \times 3$	Washer $\phi 10 \times 30 \times 3$
20	42.08.11	Silentbloc completo	Complete silentbloc
21	42.08.08	Parte inferiore morsetto	Lower part U-bolt
22	42.08.13	Vite T.E. $\phi 8 \times 30$	Hexagonal-headed screw $\phi 8 \times 30$
23	42.08.31	Parte superiore morsetto	Upper part U-bolt
24	42.08.15	Tappo forcella	Fork cap
25	42.08.16	Anello tenuta tappo	Cap seal ring
26	42.08.01	Trapezio superiors	Upper trapezium
27	42.08.23	Rondella dado cannotto	Sleeve washer
28	42.08.19	Dado cannotto $\phi 24$	Sleeve nut $\phi 24$
29	42.08.32	Vite T.C.C.E. $\phi 8 \times 30$	Cheese-headed socket screw $\phi 8 \times 30$
30	42.08.05	Canotto sterzo	Steering sleeve
31	15.06.14	Copricalotta sterzo	Steering cover guard
32	19.02.21	Cono sterzo	Steering cone
33	19.02.20	Calotta sterzo	Steering cover
34	24.03.05	Sfera $\phi 1/4$ "	Steel ball $\phi 1/4$ "
35	42.08.02	Trapezio inferiors	Lower trapezium
36	42.08.33	Anello elastico	Circlip
37	42.08.06	Gamba sinistra	Left leg
38	42.08.34	Vite T.C. $\phi 6 \times 8$	Screw T.C. $\phi 6 \times 8$
39	21.01.23	Rondella alluminio $\phi 6$ 831/47	Aluminium washer $\phi 6$ 831/47

**Table 20B: Handlebars (Disk brake)**

No.	Code	Denominazione	Description
1	41.02.01	Manopola sinistra	Left-hand grip
2	41.02.17	Leva sinistra	Left-hand lever
3	41.02.06	Vite fissaggio leva	Lever securing screw
4	41.02.07	Dado fissaggio leva	Lever securing nut
5	41.02.30	Supporto orientabile sinistro nudo	Bare left-hand adjustable support
6	41.02.23	Rondella filettata registro trasmissione	Threaded washer for driving gear adj.
7	41.02.22	Registro trasmissione	Driving gear adjuster
8	36.01.20	Trasmissione frizione	Clutch drive
9	41.01.14	Manubrio nudo NORMALE	STANDARD bare handle bar
10	41.02.02	Manopola destra	Right-hand grip
11	41.02.16	Comando gas nudo	Bare gas control
12	36.01.21	Trasmissione carburatore lunga NORMALE	STANDARD long carburettor cable
13	36.01.22	Trasmissione carburatore corta NORMALE	STANDARD short carburettor cable
14	41.02.20	Supporto orientabile sinistro completo	Complete left-hand adjustable support
15	41.01.15	Impugnatura sinistra nuda SPORT	SPORT bare left-hand grip
16	36.01.25	Trasmissione carburatore lunga SPORT	SPORT long carburettor cable
17	36.01.26	Trasmissione carburatore corta SPORT	SPORT short carburettor cable
18	41.01.16	Impugnatura destra nuda SPORT	SPORT bare right-hand grip
	41.01.18	Impugnatura destra compl. SPORT	SPORT complete right-hand grip
	41.01.19	Impugnatura sinistra compl. SPORT	SPORT complete left-hand grip
	41.01.20	Manubrio compl. NORMALE	STANDARD complete handle bar