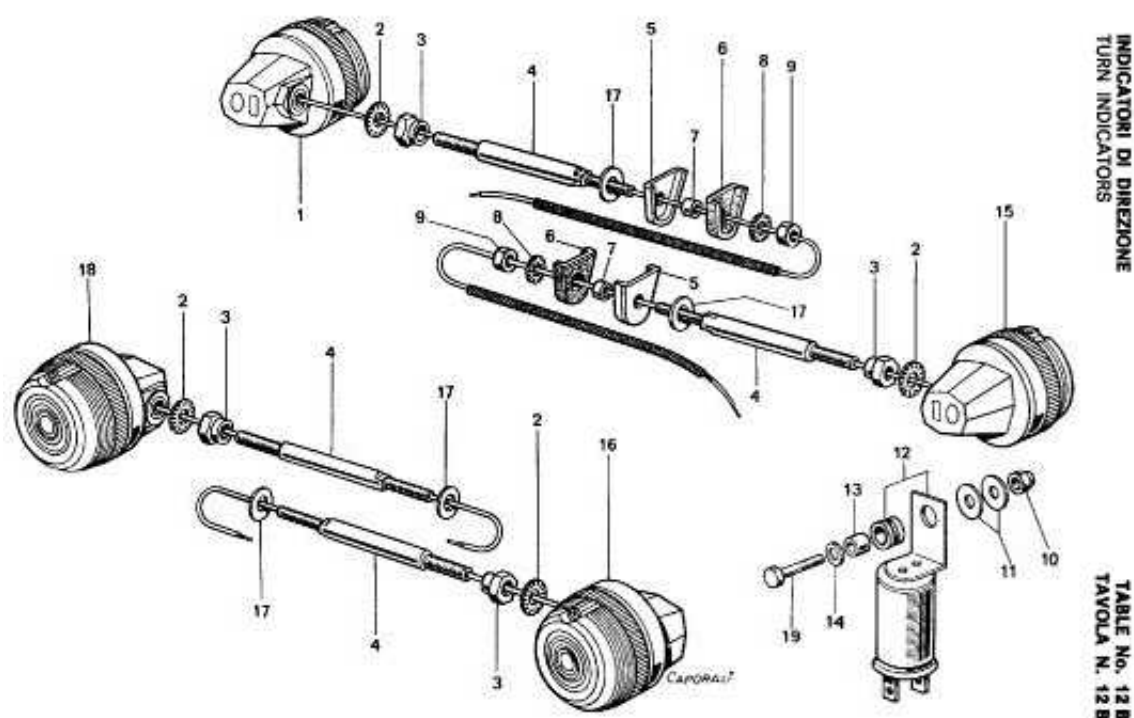

**Table 12B: Indicators**

No.	Code	Denominazione	Description
1	46.01.35	Indicatore posteriore destro Mod. 9373.13	Right side rear turn indicator
2	47.08.12	Rondella ventaglio $\phi 10$	Fan-shaped washer $\phi 10$
3	46.01.38	Dado cromato Mod. 18744	Chrome nut Mod. 18744
4	46.01.22	Perno cromato Mod. 18284	Chrome pin Mod. 18284
5	15.06.42	Astuccio per antivibrante	Case for vibration damper
6	30.01.45	Antivibrante	Vibration damper
7	14.05.22	Boccolina per antivibrante	Bushing for vibration damper
8	47.08.11	Rondella a ventaglia $\phi 8$	Fan-shaped washer $\phi 8$
9	47.03.12	Dado $\phi 8 \times 6,5$ VT. 313	Nut $\phi 8 \times 6,5$ VT. 313
10	47.03.04	Dado $\phi 6 \times 5$ VT. 302	Nut $\phi 6 \times 5$ VT. 302
11	47.07.13	Rondella piana $\phi 6 \times 18$ VT. 716	Flat washer $\phi 6 \times 18$ VT. 716
12	46.01.24	Intermittenza	Intermittence
13	14.05.11	Boccolina per antivibrante	Bushing for vibration damper
14	47.07.03	Rondella piana $\phi 6 \times 13$ VT. 702	Flat washer $\phi 6 \times 13$ VT. 702
15	46.01.33	Indicatore posteriore sinistro Mod. 9372.12	Left side rear turn indicator
16	46.01.34	Indicatore anteriore sinistro Mod. 9373.12	Left side front turn indicator
17	47.07.07	Rondella piana $\phi 8 \times 18$ VT. 707	Flat washer $\phi 8 \times 18$ VT. 707
18	46.01.36	Indicatore anteriore destro Mod. 9372.13	Right side front turn indicator
19	47.01.06	Vite T.E. $\phi 6 \times 22$ VT. 105	Hexagonal-head screw $\phi 6 \times 22$ VT. 105