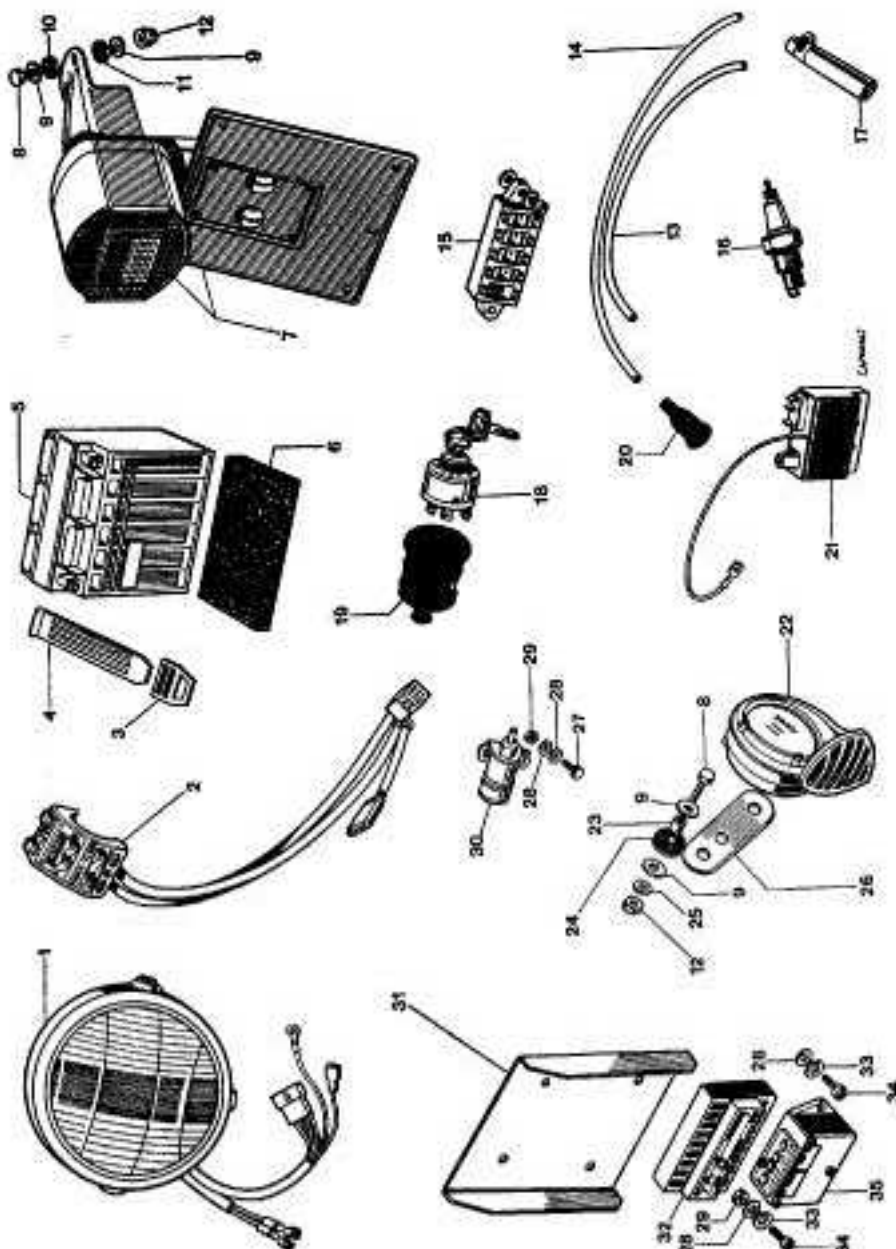

**Table 12A: Electrical Components**

FANALE - PORTATARGA - BATTERIA - TROMBA  
 HEADLIGHT - LICENSE PLATE HOLDER - BATTERY - HORN

TAVOLA N. 12 A  
 TABLE No. 12 A



No.	Code	Denominazione	Description
1	46.01.31	Proiettore Mod. 4045	Headlight Mod. 4015
2	46.01.32	Dispositivo luci Mod. 8183	Lighting device Mod. 8183
3	15.04.01	Gancia fascetta batteria	Battery clamping hook
4	30.01.14	Fascetta batteria	Battery clamp
5	46.02.05	Batteria	Battery
6	21.01.67	Sottobatteria	Battery bottom
7	46.01.13	Portatarga	License plate holder
8	47.01.06	Vite T.E. $\phi 6 \times 22$ VT. 105	Hexagonal-head screw $\phi 6 \times 22$ VT. 105
9	47.07.13	Rondella piana $\phi 6 \times 18$ VT. 716	Flat washer $\phi 6 \times 18$ VT. 716
10	21.01.65	Rondella gommatela	Rubber warp lock washer
11	21.01.51	Rondella gommatela	Rubber warp lock washer
12	47.03.13	Dado autobloccante $\phi 6 \times 7,6$ VT. 314	Self-locking nut $\phi 6 \times 7,6$ VT. 314
13	46.04.22	Filo candela corto	Short sparkplug wire
14	46.04.21	Filo candela lungo	Long sparkplug wire
15	46.02.33	Morsettiera mini Mod. 0.4538.9	Small-sized terminal board Mod. 0.4538.9
16	46.02.08	Candela AC 42 - XLS	Sparkplug AC 42 XLS
17	46.02.19	Attacco candela	Sparkplug connection
18	46.02.26	Commutatore a chiave Mod. 8180.1	Key-type switch Mod. 8180.1
19	46.02.14	Cappuccio commutatore Mod. 16710	Switch hood Mod. 16710
20	46.04.24	Cappellotto filo candela	Sparkplug wire hood
21	46.05.07	Trasduttore	Transducer
22	46.02.03	Tromba	Horn
23	14.05.11	Boccola antivibrante tromba	Shakeproof horn bushing
24	30.01.26	Passacavo in gomma Art. 843	Rubber fairlead Ref. N. 843
25	47.07.03	Rondella piana $\phi 6 \times 13$ VT. 702	Flat washer $\phi 6 \times 13$ VT. 702
26	15.06.15	Staffa sostegno avvisatore acustico	Warning horn supporting bracket
27	47.01.02	Vite T.E. $\phi 5 \times 10$ VT. 101	Hexagonal-head screw $\phi 5 \times 10$ VT. 101
28	47.07.02	Rondella piana $\phi 5 \times 11$ VT. 701	Flat washer $\phi 5 \times 11$ VT. 701
29	47.03.03	Dado $\phi 5 \times 5$ VT. 301	Nut $\phi 5 \times 5$ VT. 301
30	46.02.09	Interruttore stop	Stop switch
31	15.06.18	Pannello porta morsettiera	Terminal board holding panel
32	46.02.34	Morsettiera porta fusibili	Fuses terminal box
33	47.08.02	Rondella elastica $\phi 5$	Spring washer $\phi 5$
34	47.02.19	Vite T.C. $\phi 5 \times 16$ VT. 228	Socket screw $\phi 5 \times 16$ VT. 228
35	46.05.09	Regolatore	Regulator